

**ELECTRIC ACTUATOR
V2 Series**



FRANK
OF



V2 ELECTRIC ACTUATOR

i-Tork controls designs, produces and provides high quality electric actuator and services related to industrial valve automation and controls.

V2 series Quarter-turn actuator has been developed for Specialized Portable Chiller System in Semiconductor factory applications and to service reliable performance, long trouble free operation, more flexibility and maximized ability to integrate fully into sophisticated control system.

Housing

ABS (Acrylonitrile Butadiene Styrene copolymer) with Electrical properties, Impact resistance and Chemical & Oil resistance

Digital display controller (Option)

with Digital positioning indicator for easy operation

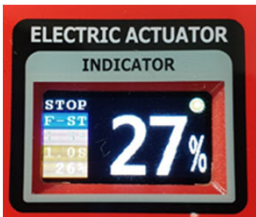

Cable gland

M12 (AWG24 x 6C – 3m)

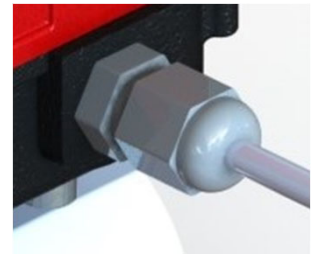

Flange : F03



Body

Hard anodized aluminum alloy body with external powder coating against corrosive industrial environment

V-Port Ball Valve

If need a different type of valve, please consult with i-Tork.

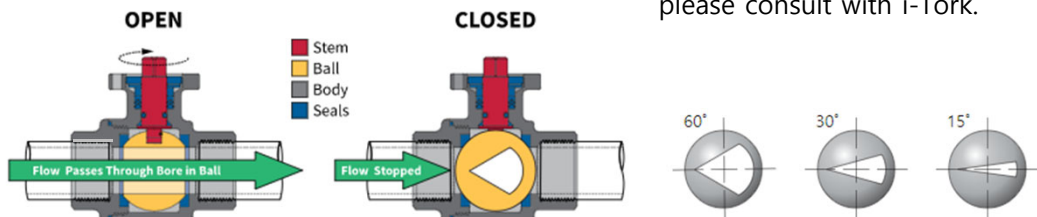

V2 ELECTRIC ACTUATOR

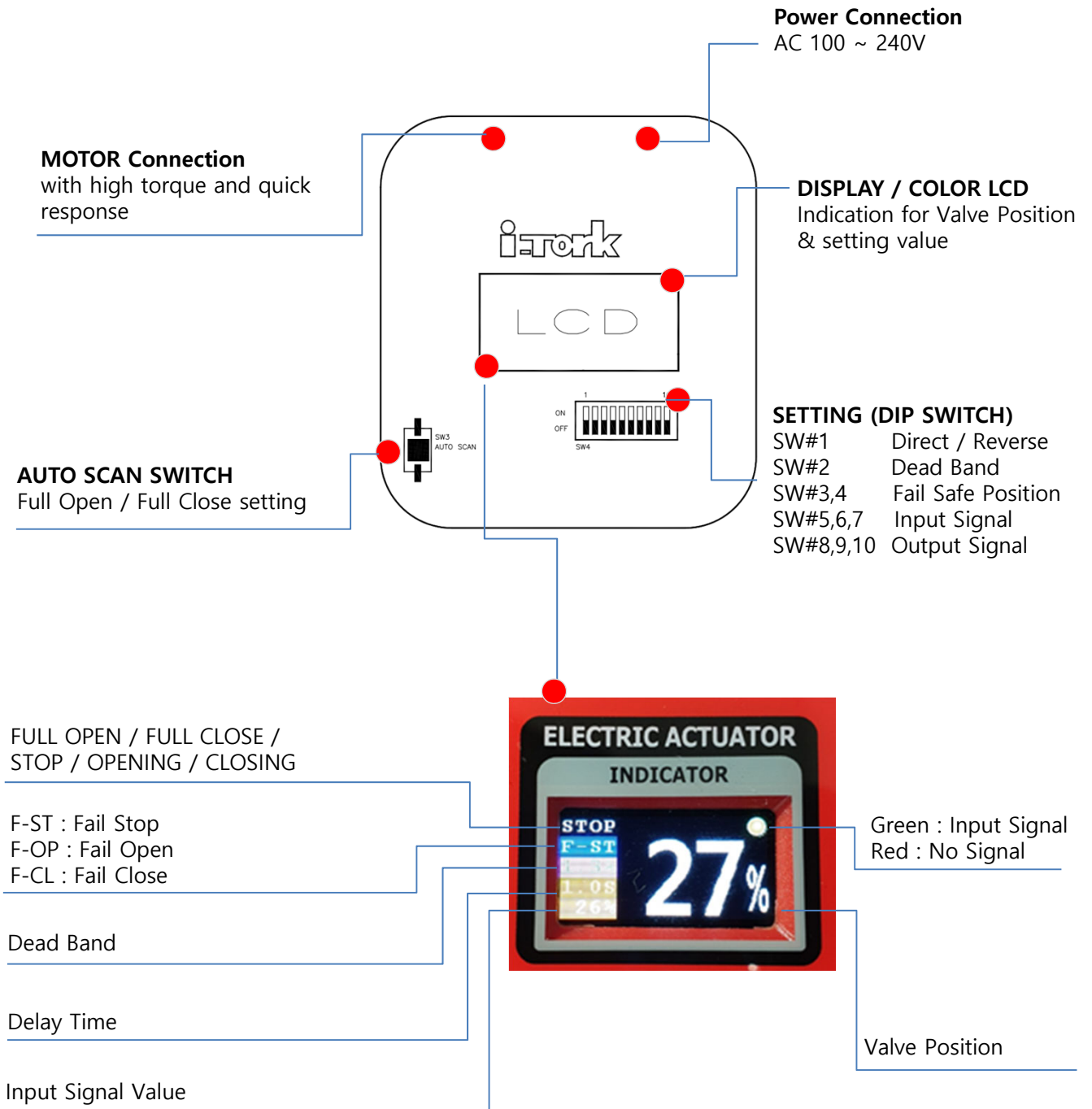

V2 ELECTRIC ACTUATOR

Technical Data

	V2	REMARK
MAIN POWER	FREE VOLTAGE AC 220V 50/60 Hz (AC 100V ~ 240V)	
INPUT SIGNAL	$\frac{*4\sim 20\text{mA}}$ (0~20mA / 2~10V / 0~10V / 1~5V / 0~5V)	DIP Switch # 5,6,7
OUTPUT SIGNAL	$\frac{*4\sim 20\text{mA}}$ (0~20mA / 2~10V / 0~10V / 1~5V / 0~5V)	DIP Switch # 8,9,10
OPERATING TIME	5 sec	Full Range
ACTION MODE	DIRECT / REVERSE MODE	DIP Switch #1
FAIL SAFE POSITION	FULL OPEN / FULL CLOSE / STOP	DIP Switch #3,4
DEAD BAND	WIDE 2.5% / NARROW 1.3%	DIP Switch #2
DUTY CYCLE (MODULATING)	Higher than 1200 Start / hour	
NOISE SKIP	Less than 0.2V	
DISPLAY	COLOR LCD	(OPTION)
TRAVEL ANGLE	90°	Open방향+5°
INSULATION CLASS	MINIMUM 100MΩ (DC 500V)	(PCB)
OVERLOAD PROTECTION	Output :Hiccup Protection Input :Fuse Protection	
AMBIENT LIMITS TEMPERATURE	-20°C~+60°C	
MATERIALS	HOUSING : body-Aluminum Die Casting , Cover-ABS GEAR : STEEL,	
HOUSING PROTECTION GRADE	WEATHERPROOF IP66	
RANGE(Ball Valve) / Torque(Nm)	1/4" ~ 2" / 4 Nm	
WEIGHT(kg)	0.4 Kg	(Without Valve)

* i-Tork Standard

V2 ELECTRIC ACTUATOR

Dimensions(mm)

V2 with Digital Indicator

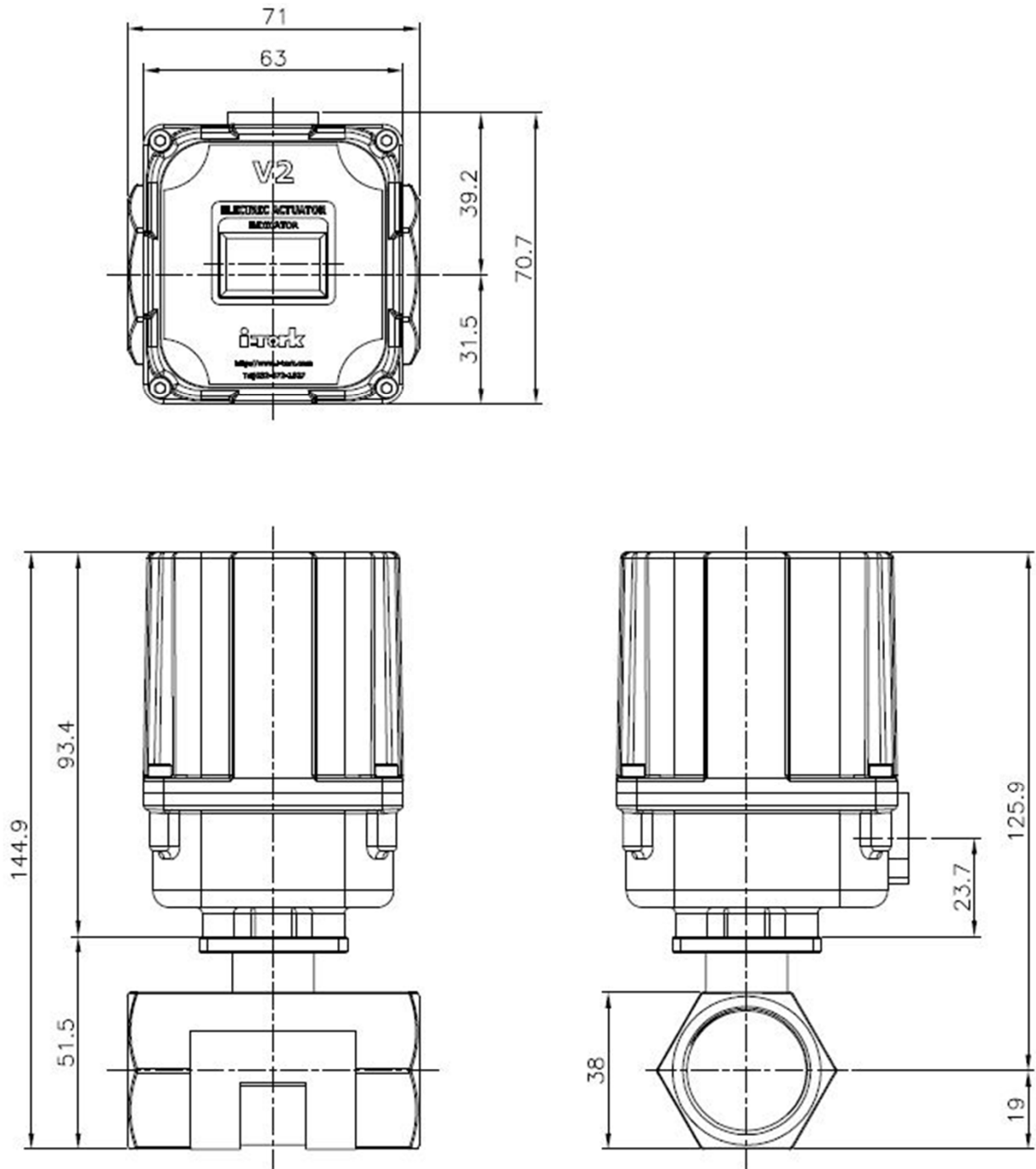

The details of this catalog are subject to change without prior notification.

 **CONTROLS Co., Ltd.**

Website : <http://www.i-tork.com>

REGIONAL SALES OFFICE - South East Asia

AHF Engineering Sdn. Bhd. (Company Reg. No: 200901015119)

No 5, Jalan USJ 1/31, Taman Subang Permai, 47600 Subang Jaya, Selangor D.E., MALAYSIA

Tel. (Office) : +603-8024-0940 Fax (Office) : +603-8024-0941 Email : sales@ahfengineering.com
cky@ahfengineering.com

© I-TORK[®] Controls Co., Ltd. All rights reserved. ICS-CA-1603
